

Visit



mytracmo.com

廠牌：Tracmo, Inc.
型號：T402

tracMo is a trademark of TRACMO, INC.
©2019 TRACMO, INC. All Rights Reserved. Patent Pending in the USA, Japan and China. All other trademarks are properties of their respective owners.

如何使用

請注意：

tracMo Station 並未附帶 USB 電源轉接器，請取得 USB 轉接器以連接電源。tracMo Station 與市面上的大部分手機 USB 電源轉接器或配件相容。

1. 請把 tracMo Station 插上 USB 電源轉接器。
2. 放置於家中欲追蹤物品附近 (不超過 10 至 20 公尺) 且接收 WiFi 訊號較佳的位置並接上電源 (接上電源後 LED 燈此時會亮起)。
3. 從 Apple Store 或 Google Play 搜尋「tracMo」下載 tracMo app，或掃描下方 QR Code 下載。



4. 進入 tracMo app，於 app 中的新增裝置 (有 + 號符號的按鈕) 裡點選 tracMo Station 並依指示步驟將 tracMo Station 連上 WiFi。

5. tracMo Station 連上 WiFi 後，請於地圖上選擇您的所在位置。
6. 上述步驟完成後，tracMo 會自動進行更新，初始化更新需一段時間，在此期間請勿拔除 tracMo Station 電源。
7. 當 LED 燈轉為呼吸模式時，此時可將 tracMo Station 與您的其他 BLE 裝置連結。回到 APP 首頁點選新增裝置中的廣泛追蹤，tracMo Station 會顯示出可追蹤的所有藍牙裝置於列表上。

注意事項

- tracMo Station 運作期間，須保持電力來源無虞及 WiFi 的連線方能正常運作。
- 產品運作時，LED 燈狀態指引：
 - (1) 長亮：資料傳輸中，請勿拔掉 tracMo Station 電源
 - (2) 長時間快速閃爍：有連線問題，請檢查 WiFi 連線
 - (3) 呼吸：正常運作中

保固服務

每一只 tracMo Station 都有享有為期一年的保固服務。當您申請保固維修時，必須知會 TRACMO (support@mytracmo.com) 以獲得返修授權 (RMA)。更多關於保固的資訊，請參見 www.mytracmo.com/warranty。

中華民國法規遵循(NCC)

低功率電波輻射性電機管理辦法：

第12條 經型式認證合格之低功率射頻電機，非經許可，公司、商號或使用者均不得擅自變更頻率、加大功率或變更原設計之特性及功能。

第14條 低功率射頻電機之使用不得影響飛航安全及干擾合法通信；經發現有干擾現象時，應立即停用，並改善至無干擾時方得繼續使用。前項合法通信，指依電信法規定作業之無線電通信。低功率射頻電機須忍受合法通信或工業、科學及醫療用電波輻射性電機設備之干擾。

按鈕位置

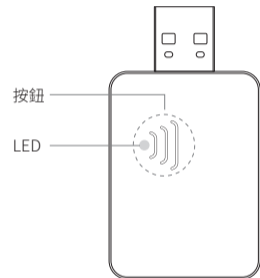

按鈕點擊一下與您的手機配對。

tracMO Station
[USER MANUAL]

(English、中文)

QUICK START GUIDE

Note: tracMo Station does not come with a USB power adapter which it requires for connecting to a power outlet. tracMo station is compatible with most USB power adapters for phones or phone accessories.

1. Connect the tracMo Station with a USB power adapter.
2. Plug in the connected tracMo Station in a power outlet within the WiFi coverage and is also within 10-20 meters of your trackable items. The blue LED light should come on.
3. Download the tracMo App from the App store or Google Play by searching for "tracMo" or scanning the QR Code below.



4. Enter the tracMo app, and add tracMo Station by touching the 'add device' icon (the one with a "+" sign) and follow the instructions to connect the tracMo Station to WiFi.

5. After connecting to WiFi you will be asked to select your location on the map.
6. Once above steps are completed, the tracMo Station will start an initialization which might take a few minutes, please do not unplug the tracMo Station during this time.
7. When the LED turns to a breathing pattern, you can start using the tracMo Station to track tracMo trackers and many other BLE devices by simple adding them via "add device". tracMo Station compatible third party BLE devices will show up in the "Universal Tracking" list.

CAUTIONS

- tracMo Station requires power and WiFi connections.
- LED status guide:
 - (1) Always on: data transfer, please do not unplug
 - (2) Blinking for a long period: issues with network connection, please check the WiFi connection
 - (3) Breathing: operating normally

WARRANTY SERVICE

Each tracMo Station comes with One Year warranty service. Consumers requesting repairs under warranty must notify TRACMO (support@mytracmo.com) to obtain a Return Material Authorization (RMA). Please visit www.mytracmo.com/warranty for more info.

CERTIFICATIONS & APPROVALS

FCC Statement

This device complies with part 15 of the FCC Rules. Operation is subject to the following two conditions: (1) This device may not cause harmful interference, and (2) this device must accept any interference received, including interference that may cause undesired operation.

NOTE: This equipment has been tested and found to comply with the limits for a Class B digital device, pursuant to part 15 of the FCC Rules. These limits are designed to provide reasonable protection against harmful interference in a residential installation.

This equipment generates, uses and can radiate radio frequency energy and, if not installed and used in accordance with the instructions, may cause harmful interference to radio communications. However, there is no guarantee that interference will not occur in a particular installation. If this equipment does cause harmful interference to radio or television reception, which can be determined by turning the equipment off and on, the user is encouraged to try to correct the interference by one or more of the following measures:

- Reorient or relocate the receiving antenna.
- Increase the separation between the equipment and receiver.
- Connect the equipment into an outlet on a circuit different from that to which the receiver is connected.
- Consult the dealer or an experienced radio/TV technician for help.

Changes or modifications not expressly approved by the party responsible for compliance could void the user's authority to operate the equipment.

Industry Canada (IC) Compliance Notice

This device complies with Industry Canada license-exempt RSS standard(s). Operation is subject to the following two conditions: (1) this device may not cause interference, and (2) this device must accept any interference, including interference that may cause undesired operation of the device.

Le présent appareil est conforme aux CNR d'Industrie Canada applicables aux appareils radio exempts de licence. L'exploitation est autorisée aux deux conditions suivantes: (1) l'appareil ne doit pas produire de brouillage, et (2) l'utilisateur de l'appareil doit accepter tout brouillage radioélectrique subi, même si le brouillage est susceptible d'en compromettre le fonctionnement.

• Location of the push button

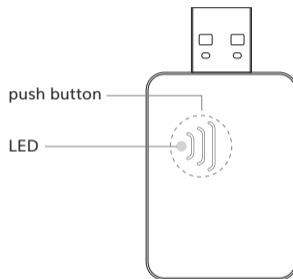

Pairing Station with your phone by one-clicking here.